

Electric pump **EL604HC**

DRAFT

Technical specifications:

Capacity:	720 m ³ /h
Head:	16m
Voltage/Current:	400 V / 131 A
Weight:	1300 Kg
Cross Section:	ø 90 mm
Impeller:	2 vanes closed / ø 306 mm
Bore:	ø 250 mm

Electric motor:

Phases/poles/frequency:	3 / 6 / 50 Hz
Motor Output:	75 kW (100 HP)
Speed:	1450 R.P.M.
Motor Insulation:	Class F

Materials:

Main Body: spheroidal cast iron GS500.
 Motor Housing: cast iron G25.
 Wearing parts: high chrom.
 Main Shaft: austempering NiCrMo4 Steel.

Seals:

Seals motor zone: n°2 rubber lip seals.
 Seals impeller zone: n°1 polyuretane V-RING n°1 COMBY lip seal n°2 box duble lip seals.

Performance Curve

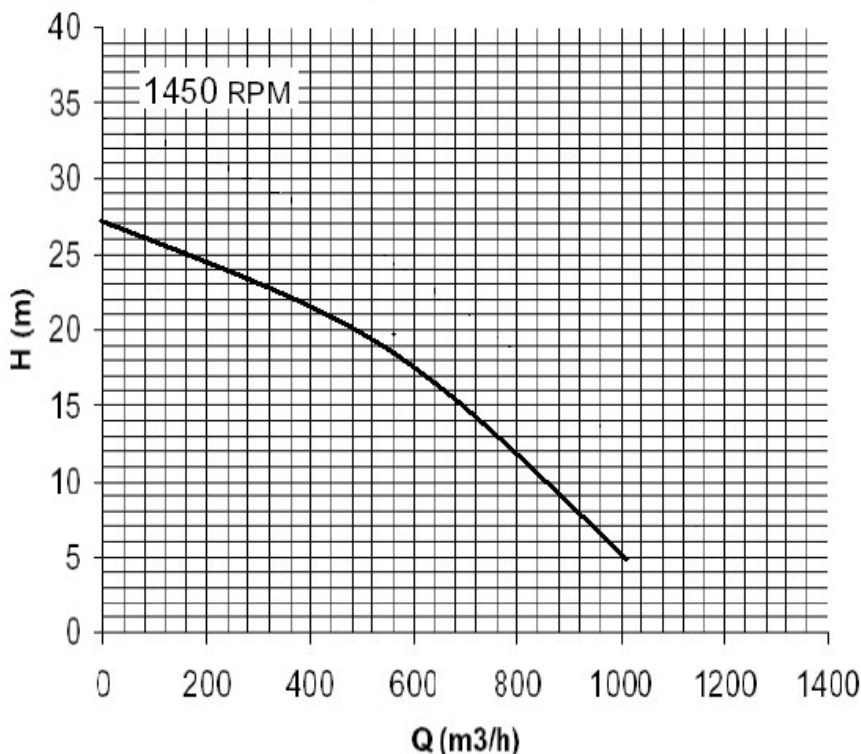

Dimensions

A [mm]	1660
B [mm]	450
C [mm]	548
D [mm]	997
E [mm]	449
F [mm]	467
G [mm]	478
H1 [mm]	995
H2 [mm]	340
I [mm]	1140

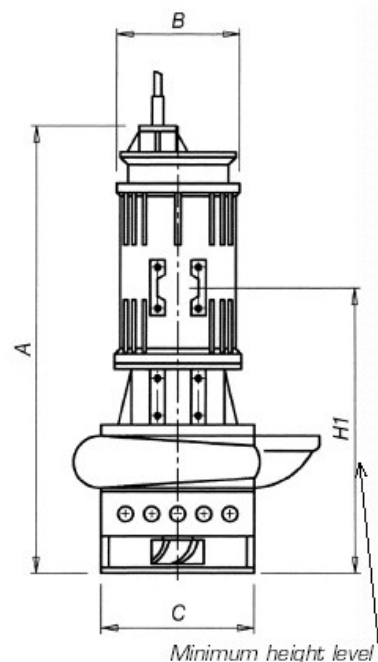
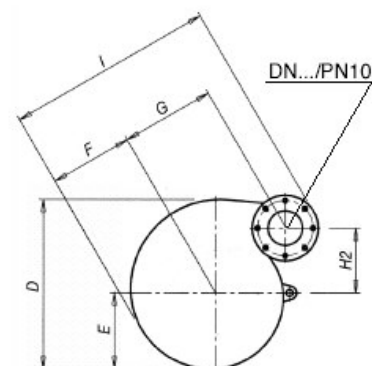

gruppoel.it